

Creating Text

Tajima SAI

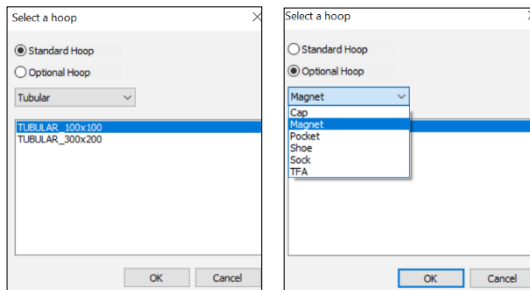

1. Open Tajima Writer Plus Software.
2. View > turn on Hoop > a check mark will appear when hoop is activated.
3. Edit > Select Hoop. You will have two options, Standard or Optional. Standard is the two hoops that came with the machine. Optional will show you all the hoops available for the machine. Select Standard Hoop > Tubular > Tubular 300 x 200 > OK.



4. Fit to screen.

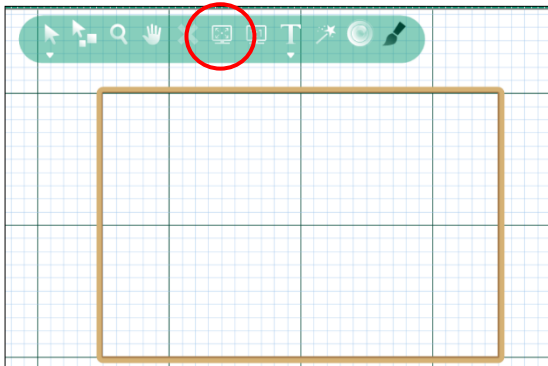

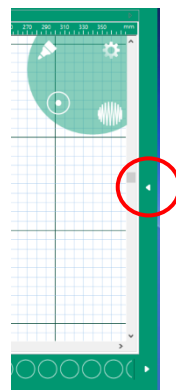
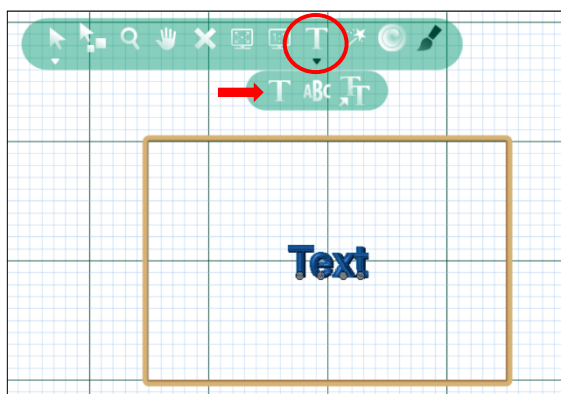

5. Click on the drop down arrow under the “T”. Click on the “T”. The word text will appear on your screen. On the right side of the screen is a white arrow, click on this arrow to open the Properties box.



JUKI

Creating Text

- In the properties box on the right, click on Text and type in your name or wording. Click on Height to change the size or click on Select Tool > select the text > click and hold the corner box to change the size of the text. Click on  to move text around. Click  to rotate text.
- Click on the drop down arrow beside Font to see all the built in options for font styles. Note: For true type fonts, click on the down arrow under the "T" and select 

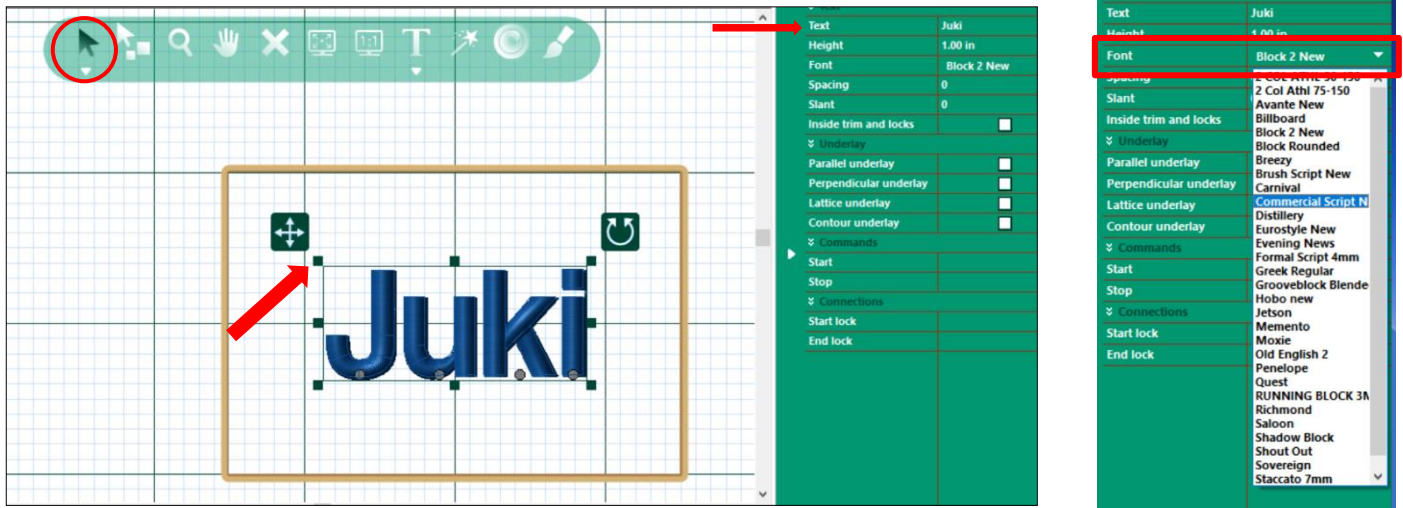

- Spacing > move each individual letter closer or further apart.
- Slant > change the angle of the text.

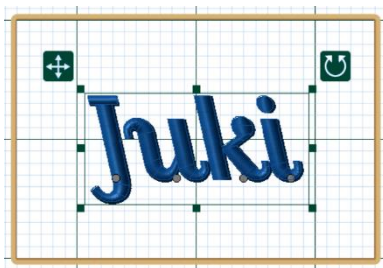

Text	Juki
Height	1.00 in
Font	Moxie
Spacing	-1
Slant	-20
Inside trim and locks	<input type="checkbox"/>

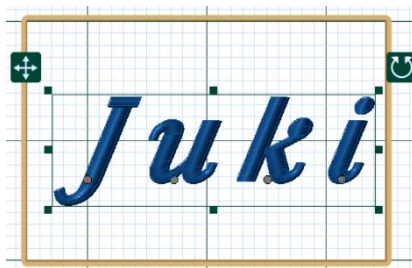

Text	Juki
Height	1.00 in
Font	Moxie
Spacing	4
Slant	15
Inside trim and locks	<input type="checkbox"/>

- Underlay > choose the type of underlay you would like to use or choose no underlay at all.

JUKI